



# The Lodge at Camp Tilikum Housing Chart

Group Name: \_\_\_\_\_

Date: \_\_\_\_\_

## Lower Level

**L  
O  
W  
E  
R  
L  
E  
V  
E  
L**

<b>101*</b> <i>Private bath located across hallway</i>	
Twin	
Lower Twin Bunk	
Upper Twin Bunk	
<b>103</b> <i>Private bath in-room</i>	
Twin	
Twin	
Twin Wall Bed	
<b>105</b> <i>Private bath in-room</i>	
Twin	
Twin	
Twin Wall Bed	
<b>107</b> <i>Private bath in-room</i>	
Twin	
Twin	
Twin Wall Bed	

<b>102 (XL)**</b> <i>Private bath in-room</i>	
XL Twin	
XL Twin	
Twin Wall Bed	
<b>104</b> <i>Private bath in-room</i>	
Twin	
Twin	
Twin Wall Bed	
<b>106</b> <i>Private bath in-room</i>	
Twin	
Twin	
Twin Wall Bed	

## Upper Level

**U  
P  
P  
E  
R  
L  
E  
V  
E  
L**

<b>201*</b> <i>Private bath located across hallway</i>	
Twin	
Lower Twin Bunk	
Upper Twin Bunk	
Lower Twin Bunk	
Upper Twin Bunk	
<b>203* XL</b> <i>Shared bath located across hallway</i>	
XL Twin	
Lower Twin Bunk	
Upper Twin Bunk	
<b>205</b> <i>Private bath in-room</i>	
Full/Double	
Lower Twin Bunk	
Upper Twin Bunk	
<b>207</b> <i>Private bath in-room</i>	
Full/Double	
Twin	
Twin Wall Bed	
<b>209</b> <i>Private bath in-room</i>	
Twin	
Twin	
Twin Wall Bed	
<b>211</b> <i>Private bath in-room</i>	
Twin	
Twin	
Twin Wall Bed	

<b>202*</b> <i>Private bath located next to the room</i>	
Single Twin	
Lower Twin Bunk	
Upper Twin Bunk	
Full/Double Futon	
Upper Twin Bunk	
<b>204* XL</b> <i>Shared bath located across hallway</i>	
XL Twin	
Lower Twin Bunk	
Upper Twin Bunk	
<b>206 (remodeled)**</b> <i>Private bath in-room</i>	
Full/Double	
Twin	
Twin Wall Bed	
<b>208</b> <i>Private bath in-room</i>	
Twin	
Twin	
Twin Wall Bed	
<b>210</b> <i>Private bath in-room</i>	
Twin	
Twin	
Twin Wall Bed	

\* Bathroom located outside of room

\*\* ADA accessible

XL Contains at least one XL twin for taller guests



# The Lodge at Camp Tilikum Map

## UPPER LEVEL

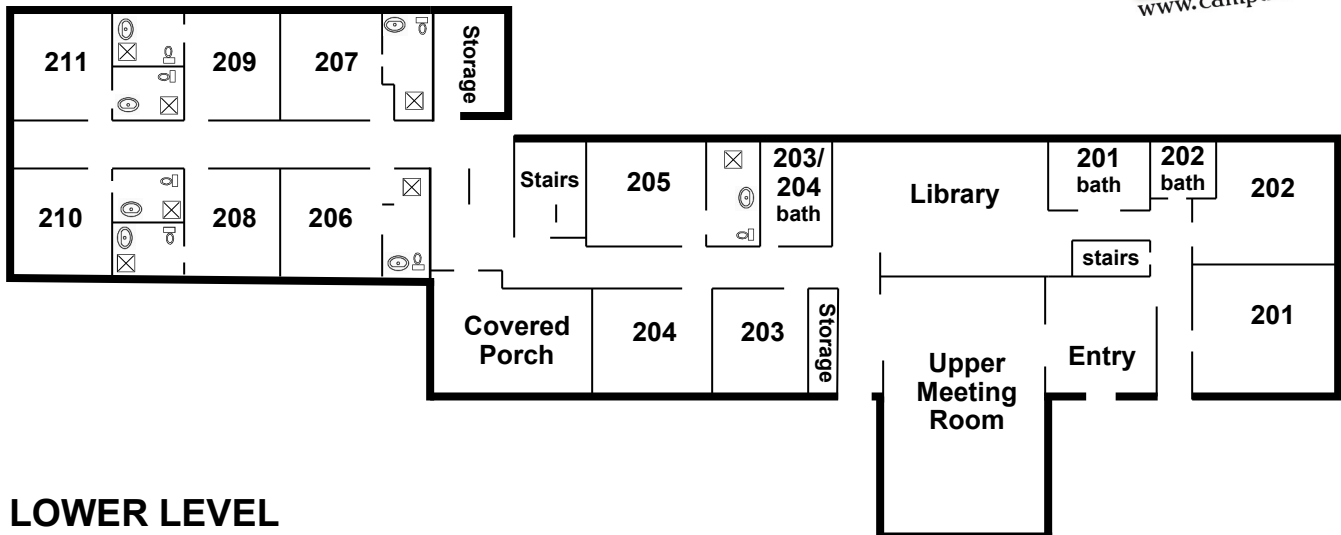

## LOWER LEVEL

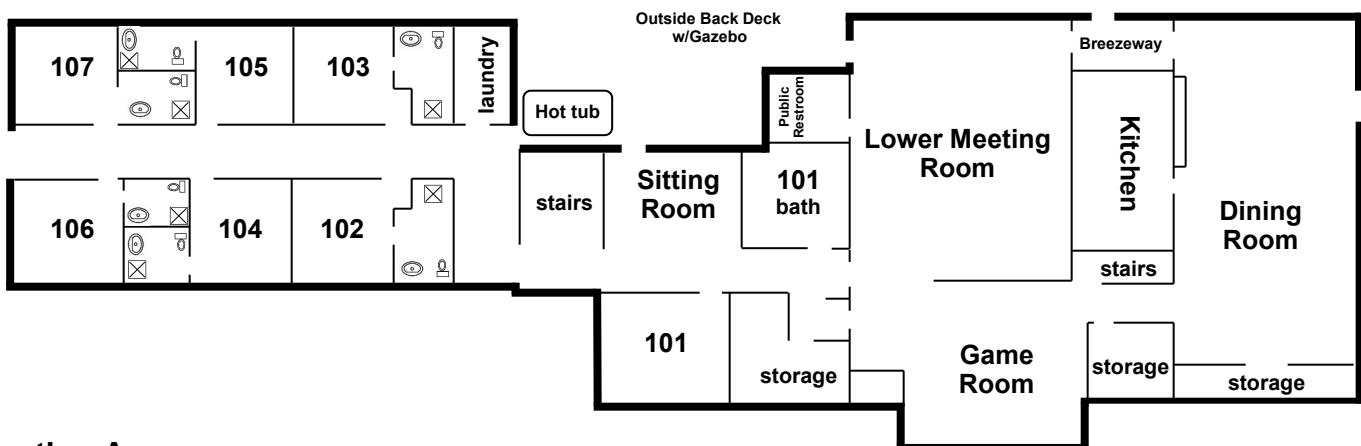

### Meeting Areas

**Upper Meeting Room** (20' x 30') - maximum capacity 40 people (theater-style seating)

TV (32" Tube Television) with VCR/DVD player, fireplace, air-conditioning

**Lower Meeting Room** (28' x 32') - maximum capacity 60 people (theater-style seating)

Piano, TV (42" flat screen) w/DVD player and connection for presentations w/PC or MAC, hand-held microphone w/stand, mini sound system, fireplace, air-conditioning

**Additional Small Group areas** - Library, sitting room, covered porch

**Additional AV equipment available upon request** - LCD projector, flip chart, whiteboard, podium, music stand

**Game Room includes:** Pool table (can be covered with a ping-pong table), foosball table

### Sleeping Rooms

**Rooms 102\*-107, 208-211** sleep up to three in single beds (1 wall bed) and include private baths in-room.

**Rooms 205** sleep up to 4 guests (1 twin-size bunk bed, 1 full-size bed) and includes a private bath in-room.

**Rooms 206\*-207** sleep up to 4 guests (1 twin bed, 1 twin wall bed, 1 full-size bed) and include private baths in-room.

**Room 101** sleeps up to three in single beds (1 twin, 1 twin bunk bed) with private bath across the hallway.

**Room 201** sleep up to 5 guests in single beds (2 twin upper bunks & 1 twin bed), private bath across hallway.

**Room 202\*** sleep up to 5 guests in 3 single beds and one double (2 upper twin bunks, 1 lower twin bunk, 1 twin bed, 1 full-size Futon), private bath is next to the room.

**Rooms 203 and 204** each sleep up to three in single beds (1 XL twin, 1 twin bunk bed) and share a common bath across the hallway.

**Extra long twin-size beds** are found in rooms 102 (2 beds in this room); 203 and 204.

\*Rooms 102 and 206 are ADA accessible